



trivum RP010

trivum REG audio actuators are flexible music systems for DIN rail mounting. All models can be combined with one another and are already ready a few minutes after installation.

Various music streaming services* as well as AirPlay can serve as music sources. Furthermore, audio files can be played locally from a NAS. All REG audio actuators support for this various audio formats with a sampling rate up to 96 kHz.

The trivum RP010 features a Line-Out port for audio output and a Volume Out interface for driving an external amplifier (eg. trivum RA410).

It is controlled by other components of trivum CONTROL series, a web browser or via KNX.

* Requires a paid subscription of the service provider.



Easy configuration

A built-in web server enables easy configuration from every PC/Mac without any additional software to be installed.



Streaming

The built-in streaming client allows you to play internet radio and music streams, as well as your own music collection via AirPlay and NAS.



Formats

The REG devices supports the most popular audio formats like MP3, AAC, ALAC, Flac, and WMA.



Custom sound

The audio actuator features a bass and treble controls for individual sound adjustments.



KNX

All REG models can be completely integrated into a KNX installation via KNX/IP router. Both control commands and status messages can be transmitted/received.



Visualization

Integration in the visualization of Jung FAP, Hager Domovea and Gira HomeServer.

Function

Audioactuator for DIN rail mounting for playback of streaming sources.

Case

Material	ABS plastic
Color	grey
Width	3 TE (53 mm)
Total weight	120 g
Mounting	DIN rail

Playback

Streaming	NAS, Tuneln, AirPlay, internet streaming services ¹
Radio	-
External sources	-
Audio files	MP3, AAC, ALAC, FLac, WMA
Sample rate	up to 96 kHz

Connections

Ethernet	RJ-45 (x1)
Radio	-
Line-In (analog) (unbalanced)	-
Line-In (analog) (balanced)	-
Line-Out (analog)	4-pin terminal block (x1)
Volume Control	2-pin terminal block (x1)
Speaker	-

Amplifier

Typ	-
Power (total)	-
Power (per channel)	-
Impedance	-
Operating temperature	-20...+50 °C

Power supply

Input voltage	24 V DC
Input current	2.5 A
Max. power consumption	60 W
Stand-by power	< 2.5 W
Power supply	not included in the scope of delivery
Connector	2-pin terminal block (x1)

Controls

trivum iPhone App, trivum TouchPad, trivum RemoteControl, KNX, web browser

Configuration

Tool	web browser Safari, Firefox, Chrome
Sound control	balance, treble, bass

KNX²

Functions	zone status, source, volume, text information, source control, actions
Visualization	Support for Gira HomeServer, Hager Domovea, Jung FAP
Connection	via KNX/IP router

Connection examples

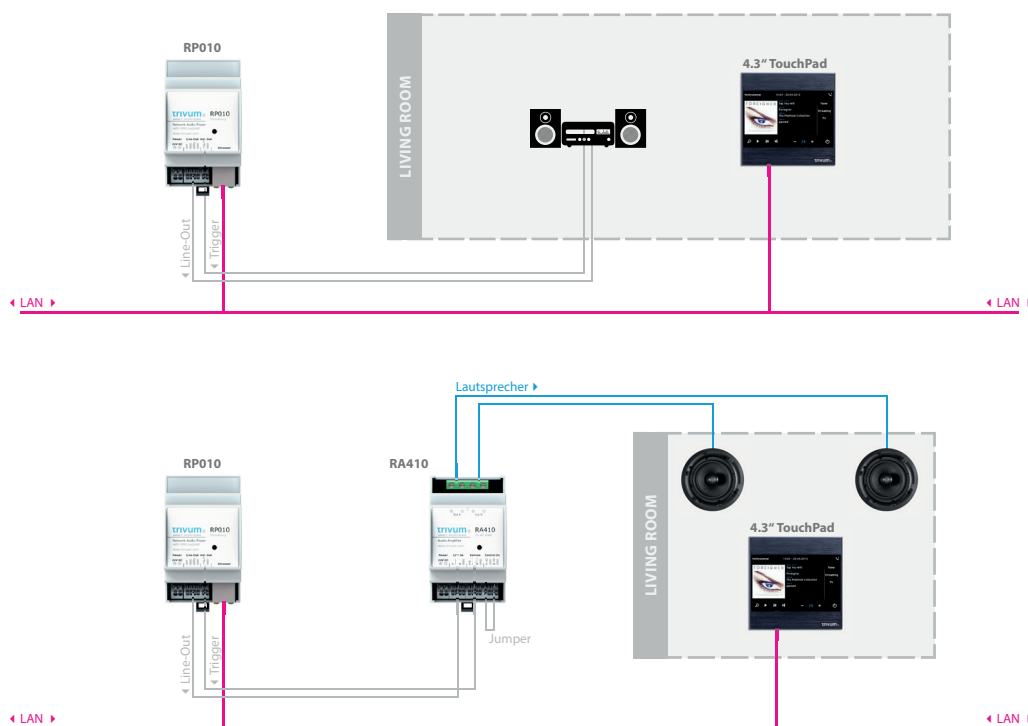

¹ please find our current list of supported online music services on www.trivum.de

² KNX is not required to use the main functions of the RP010.

